



map news



Ernie Lund, seated, with Jerry Johnson and Sam LaRocca, Sidwell Representatives.

SIDWELL DELIVERS IOWA'S FIRST AERIAL BASE TAX MAPS

These new Auditor Plat maps, covering every square inch of property, represent the first major change in the methods used to record land ownership in Washington County in 125 years. They are also the first complete inventory of real property and improvements made by any county in Iowa.

Mr. Ernie Lund, Washington County Assessor and a leading proponent of aerial tax maps as a tool for more efficient assessment, reports that substantial savings are expected with the new maps. These savings will result from improved data processing systems, added tax revenues by discovery of parcels or improvements not presently on tax rolls and more equal assessment of all parcels of property. The new maps will replace a hodgepodge of mapping scales and years of barely-readable pencilled-in property changes.

Technically known as cadastral tax maps, the new plats use precision aerial photography to show all ground features which relate to ownership, value and land

use. Each parcel of property is drawn in detail and includes dimensions, acreage and a new permanent parcel number. The numbering system enables entry of the parcel into data processing programs for such functions as tax computing, tax billing, assessments and others, replacing slower, less efficient systems. Each number can be used to replace a lengthy legal description.

The new tax maps will also be used to save time and money by other government departments. Soil maps, for example, can be overlaid on the aerial photo base maps to show tillable and non-tillable areas, exact acreages and other important information. In addition, inexpensive paper copies can be made quickly and economically from the reproducible masters for such uses as zoning, flood plain identification, sewer and water projects, highway improvement and others.

Officials in Hardin and Van Buren counties in Iowa will also be using new Sidwell plat maps in the near future.

FAST-REFERENCE MAPS OF CHICAGO AREA TOWNS

Sidwell has recently completed individual fast-reference maps of 262 towns and villages in the Chicago metro area to help delivery drivers, salesmen, real estate firms and other businesses requiring street address locations. The maps are updated with the most recent boundary changes, new annexations, street changes and many new subdivisions. An alphabetical street index for each 11 x 14" map provides an alphanumeric code for quickly locating each street on the map. In addition, house numbering systems are shown on all four edges of each map.

The new maps are available as a complete set in a durable hard cover binder, or individual maps of specific towns or villages can be ordered. Phone Map Order Dept. at 231-8200.

ELGIN, ILLINOIS TOPO-PLAN MAP SYSTEM FEATURED IN CIVIL ENGINEERING MAGAZINE

A four-page article appeared in a recent issue of Civil Engineering magazine on the multiple ways Sidwell-prepared Topo-Plan maps are saving time and money for the city of Elgin, Illinois

As reported in the article, the city was facing a growing backlog of planning and public works projects as a result of rapid population growth and annexed areas.

The Topo-Plan mapping system consists of an aerial photographic base map of the entire city and surrounding areas plus a transparent overlay showing 2' contours and elevations data. Consultants on city projects are given a set of these maps for each project.

As a result, Elgin has been able to substantially reduce the time lag and money previously spent on field surveys for each project. The precise 2'-contours on the Sidwell maps also help avoid errors which might result from the 10'-contour USGS maps often used before. And the maps provide city officials with a comprehensive "overview" for future planning.

The article also reports additional savings which have accrued to the city from other uses of the new maps by private consultants, developers, other city departments as well as county and state government.

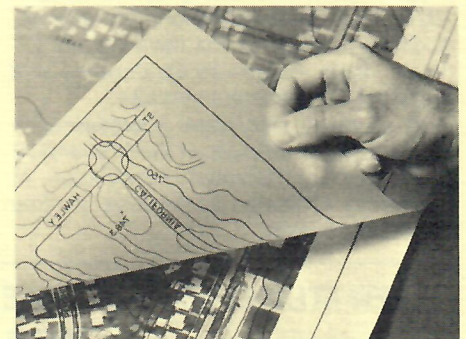

SIDWELL TOPO-PLAN SELECTED FOR PRESENTATION AT C. E. CONVENTION



Sidwell's Topo-Plan mapping system was selected for presentation as an outstanding new engineering development at a special session of the annual Civil Engineers Convention held recently in Philadelphia. Marvin Cosman, Sidwell Representative, presented a technical paper on the new mapping system at the special session. His presentation included an interesting color slide program on the development of aerial photography and photogrammetry relative to the Topo-Plan concept, with several specific applications.





SIDWELL CELEBRATES 50TH ANNIVERSARY THIS YEAR

This year marks fifty years in the mapping business for The Sidwell Company.

It all began in 1927 when Joe H. Sidwell, the company founder, cleared off the dining room table in his home in Lombard Illinois, and began producing legal descriptive maps for midwestern counties. As business increased, larger quarters were required to house office and production facilities.

The "Sidwell Studio", as it was called then, had offices in the Hammerschmidt

Building and later in Green Valley School in Lombard. Later, a move was made to the Chicago, Aurora and Elgin Railroad Substation in West Chicago.

Finally, in 1960, Sidwell Park was created, complete with our present modern building, acres of park-like grounds and two spring fed lakes.

Since then, there have been three additions to the original building and the name has been changed to simply "The Sidwell Company".



Jerry Johnson

SIDWELL TAX MAP REPRESENTATIVES SPEAK AT ASSESSORS MEETINGS



David Enders

Tax mapping and parcel numbering were topics of recent presentations given by Jerry Johnson and David Enders to state regional and national assessment groups.

Jerry was invited to appear on the program of the following conventions in 1976: Minnesota Assessors Conference, Auditors meeting of the Iowa County Officials, Iowa Assessors Conference and the Illinois Assessment Institute.

In addition, Jerry gave a presentation on mapping to officials at the first annual North Central Regional Association of Assessing Officers Conference in Eau Claire, Wisconsin.

David Enders was also in demand this past year and participated as a concurrent session speaker at the International Association of Assessing Officers Conference in Atlanta, Georgia. Dave's presentation was entitled, "Assessment Mapping and Parcel Identification Systems in the Rectangular Survey System" and was illustrated with color slides.

Dave was also on the program of the Wisconsin County Tax Listers Association Conference with a presentation on mapping and parcel numbering in Wisconsin.

NEW ATLASES NOW AVAILABLE FOR COOK AND DUPAGE COUNTIES

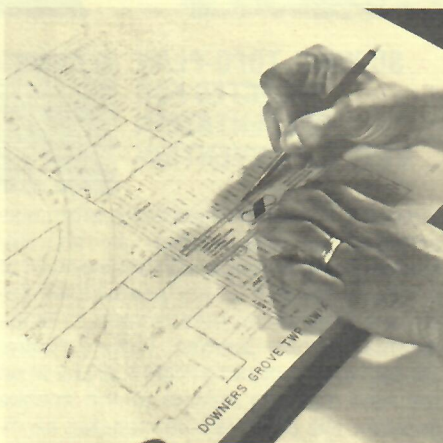

Atlases containing reduced-size copies of the official Cook and DuPage County tax maps are now available to realtors, Savings and Loans, attorneys and others requiring up-to-date property information. The convenient 11 x 17" maps for Cook County and 17 x 17" maps covering DuPage County, show all parcels of property including dimensions, subdivision names and the permanent real estate index numbers used on tax bills. Although the Cook County Atlas has been available for many years, this is the first year reduced-size DuPage tax map copies have been offered. Both atlases are updated with new property information on an annual basis.

NEW SLIDE PRESENTATION SHOWS HOW AERIAL BASE TAX MAPS GAIN MAXIMUM TAX REVENUES

A 20-minute color slide/sound presentation has been developed to show and explain how aerial base tax maps can gain maximum tax revenues and speed tax-related data processing functions for township and county governments.

The entertaining and informative presentation traces the historical development of tax assessment from early days to the present, graphically illustrating the problems being created by fast-expanding populations. The presentation also follows the similar development of aerial based tax maps with permanent parcel numbering systems, showing how these "assessment tools" are helping government officials utilize the cost-cutting efficiency of data processing systems for tax assessment, computation, billing and other functions . . . and to realize maximum tax revenues by insuring that all parcels and improvements are on the tax rolls.

The new presentation has already been shown to nearly 100 groups including county boards, assessor organizations, civic groups and other interested parties. The most recent presentation was made by David Squires and Sam LaRocca, Sidwell Representatives, to the Iowa Abstractors Association. David has also found the presentation helpful for instructing county personnel in the use of new aerial based map systems.

GARY CLARK ELECTED PRESIDENT OF A.S.P. CHAPTER

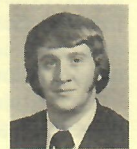

Mr. Gary Clark, Sidwell Sales Representative, has been elected President of the Illinois-Indiana Chapter of the American Society of Photogrammetry for 1977. Mr. Clark, who served last year as Vice-President, has been active in the field of photogrammetry for ten years. His background includes training as a Navy Photographic Intelligence-Man, the Armed Forces Air Intelligence School and the American School of Photogrammetry.

NEW MAPPING PROJECTS

The following new projects are scheduled to begin early this year:

- Butler County, Iowa (tax mapping)
- Tama County, Iowa (tax mapping)
- Warren County, Ohio (tax mapping)
- U.S. Corps of Engineers—Chicago (topographic mapping)
- Lake Andes/Wagner Irrigation District—S. Dakota (topographic mapping)
- City Service Oil Co.—Pipeline (aerial photography)

FOR FURTHER INFORMATION ON ANY SIDWELL MAPPING SERVICES . . .

write The Sidwell Co., 28W240 North Avenue, West Chicago, IL 60185 . . . or phone (312) 231-0206.